

QUICK START GUIDE

The Shade Store™ SmartThings

INTEGRATION SUPPORT

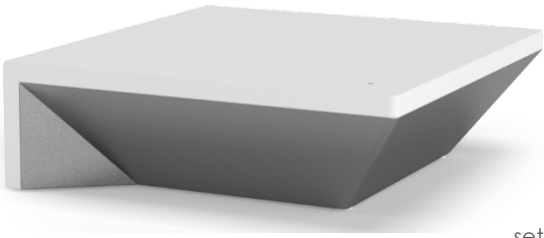

WIRELESS LINK PRO HUB OVERVIEW

Elevate your Shade Store experience by seamlessly integrating motorized shades into SmartThings Integration systems. The Pro Hub offers a powerful integration with discrete shade control and two-way communication, providing real-time updates on shade position and battery levels. Featuring both Ethernet (CAT 5) and 2.4GHz wireless connectivity, the Pro Hub ensures smooth home automation integration through an easy-to-access RJ45 port located on the back of the hub. Each hub supports up to 30 shades, making it a versatile solution for any home automation setup.

ABOUT HUB PRO AND SMARTTHINGS.

Your Pro Hub just got smarter. SmartThings is an option to works with Pro Hub to take control of your shades and integrate with many other devices in your home like, motion Sensor, Lights, Lock doors and more. All you need is an Pro Hub and a SmartThings App that you can control individual or scenes of shades with precision.

GETTING STARTED:

Go to the SmartThings App and link with your TSS App as an integration resource: Proceed to pair Motorized shades through the TSS App.

INDEX:

ABOUT PRO HUB ABD SMART THINGS	Page 1
GETTING STARTED	Page 1
CONTROLLING YOUR SHADES USING SMART THINGS	Page 1
DEVICE CONTROL	Page 1
PERCENTAGE AND STOP CONTROL	Page 2
SCENES CONTROL	Page 2
TIPS	Page 2
INITIAL SETUP:	Page 3
Linking Pro Hub on SmartThings Integration	Page 3
How to Operate the Shades from the Smart Things App	Page 6
How to Create a Scene on Smart Things App	Page 8
FAQ's	Page 9

CONTROLLING YOUR SHADES USING THE SMARTTHINGS APP:

To create a best experience on your SmartThing integration, you may to consider create friendly names TSS App. Those names will be populated automatically in our SmartThings App.

DEVICE CONTROL:

The SmartThings provide you the full control of your smart shades possibility your integration with many other devices and have the best experience of Home Automation Control in your whole house. In an individual device, you will be able to be controlling the position precisely using the slider button that you can move the shades in different position.

PERCENTAGE AND STOP CONTROL:

An individual window shade or scene can control any percentage of openness. The percentage will be based on the programmed limits on the motor. A shade that is completely raised to its upper limit is at 0%, while a shade that is completely lowered to its lower limit is at 100%. Using the SmartThings, you can stop the shades in any position between the limit programmed on the motor.

SCENES CONTROL:

Another option of operating window shade using the SmartThings App is through Scenes. These Scenes need to be setup in the SmartThing App as desired. One scene can be created using only shades or more, it's possible include many other devices to trigger the shades or have both triggering at the same time. Scenes can integrate multiple devices like shades, motion sensors, lock doors, light and much more.

TIPS:

SmartThings can be easily linked in the TSS App. It is required to create an account on SmartThings App that needs to be connected to a Smart Things Hub (GEN 2 or GEN 3) in order to allow you control as many devices as you have through only one app including the shades. Make sure that when you link the TSS App with the SmartThings App, both still under the same Wi-fi network.

TSS Pro Hub – Smart Things

Initial Set Up

First ensure your SmartThings account is setup and working. To test this, try to activate any other devices that you have connected to the SmartThings Hub. This will confirm that the SmartThings is working. Also test the TSS App and ensure the Pro Hub and Shades are working.

Linking Pro Hub on SmartThings Integration

STEP 1

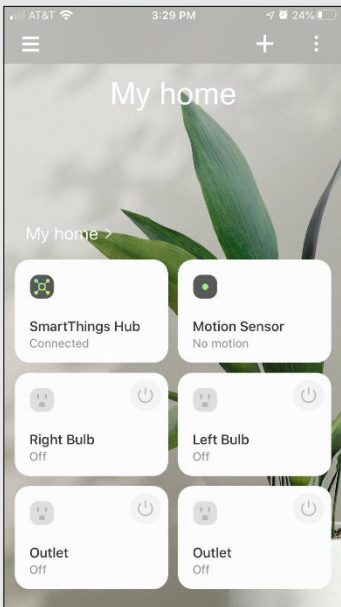

From the home page in the SmartThings App select the "plus Button (+)" in the top right corner.

STEP 2

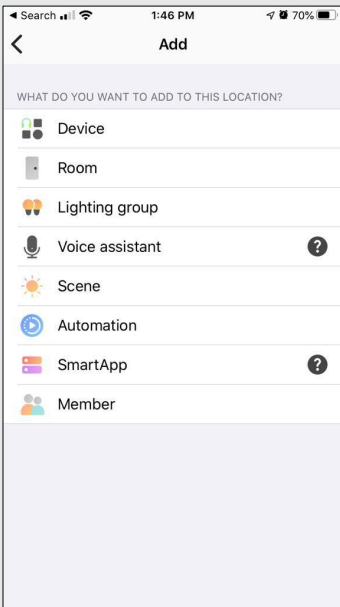

Select the "Device" option from the list.

STEP 3

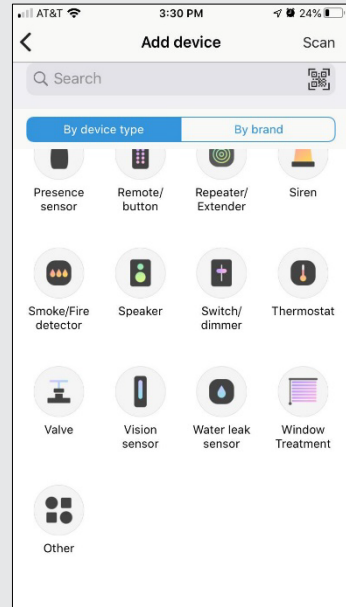

Select the "By Device Type" option and scroll down and tap "Window Treatment" icon from the list.

STEP 4

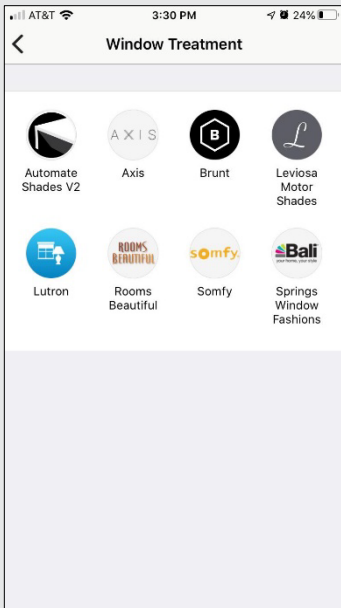

Select the "Automate Shades V2" icon to link with that specific integration.

STEP 5

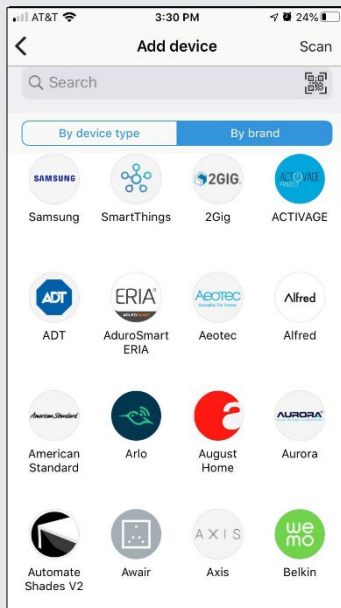

A additional option is "By Brand" on the top and select the Select the "Automate Shades V2" option from the list.

STEP 6

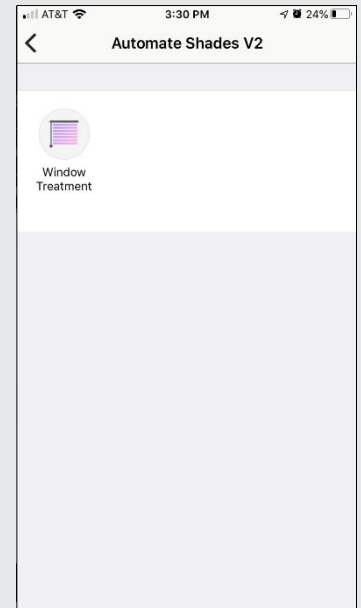

Select the "Window Treatment" icon from the list.

STEP 7

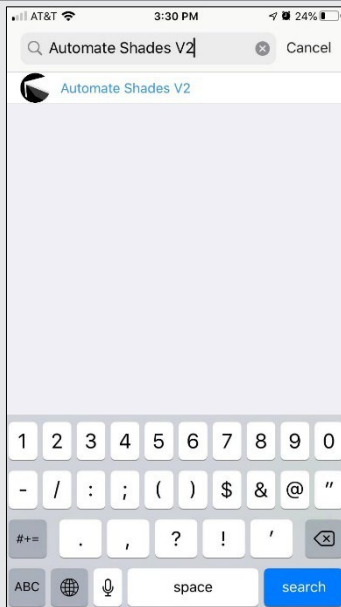

Search "Automate Shades V2" in the integration search bar at the top of the screen.

STEP 8

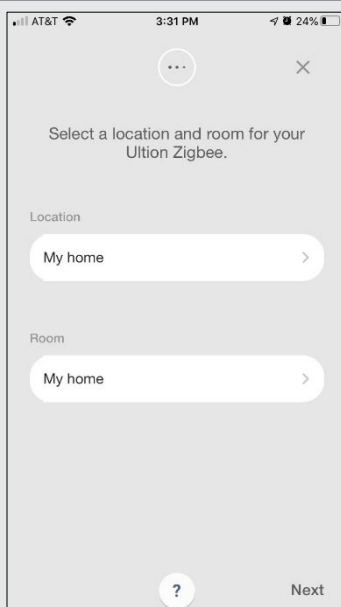

Select a "Location" and a "Room" for the Shades integration.

STEP 9

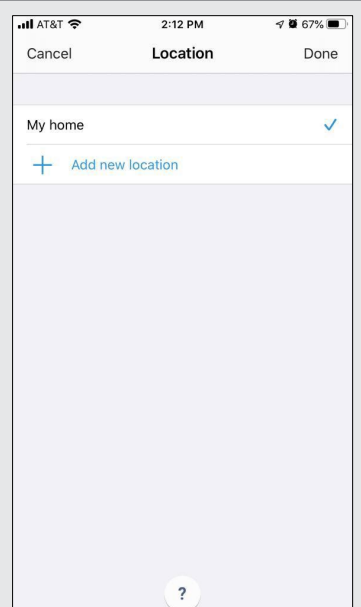

To create a new "Location", tap "Add new location" on the screen menu.

STEP 10

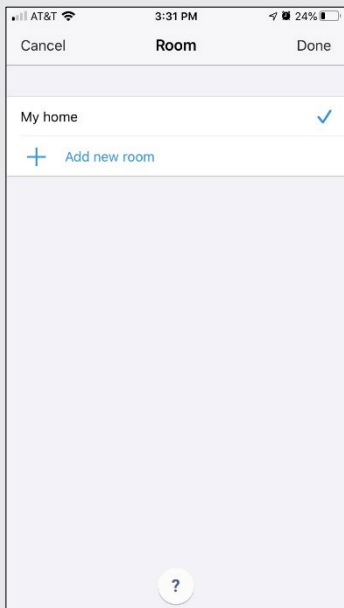

To create a new "Room", tap "Add new room" on the screen menu.

STEP 11

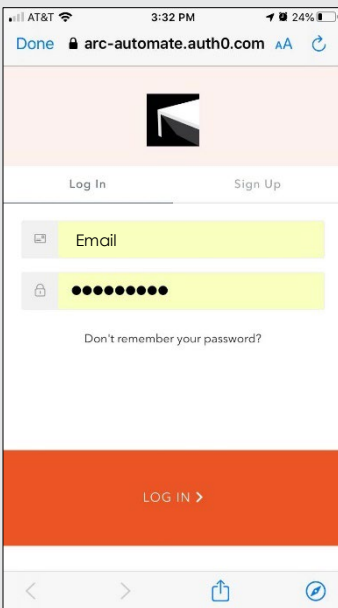

Enter the email and password associated with your TSS App you would like to link.

STEP 12

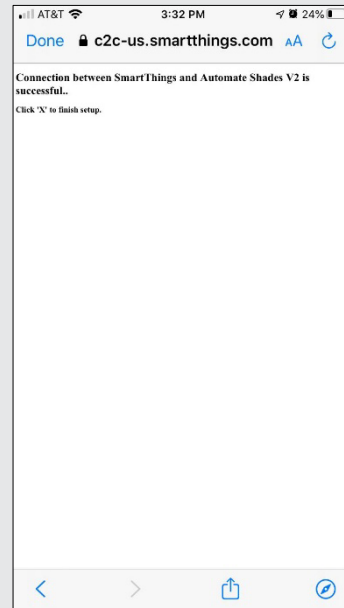

Once the account is linked, this page will appear. Select done in the top left corner

STEP 13

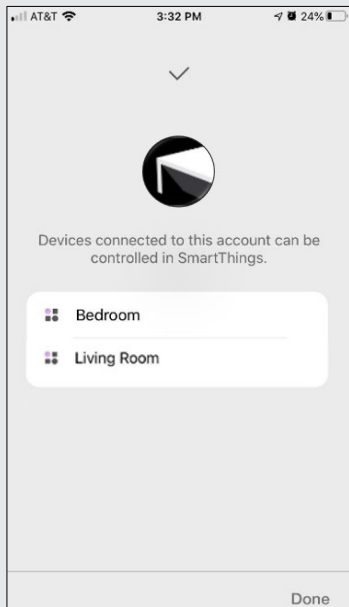

Click in "Done" to add all individual shades configured in your TSS App will now appear.

How to Operate the Shades from the SmartThings App

Control the Shades individually from the SmartThing and move to a precise position as desired.

STEP 17

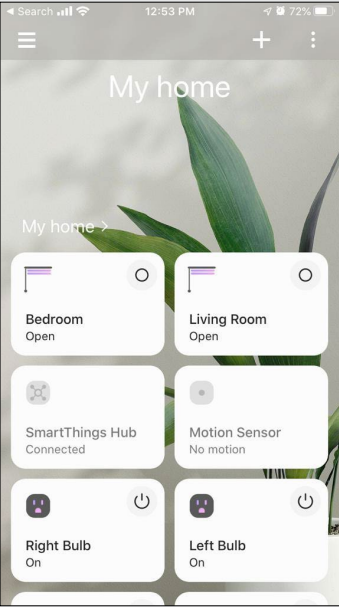

On the Home Screen, press the "Shade Icon" to start controlling your shade.

STEP 18

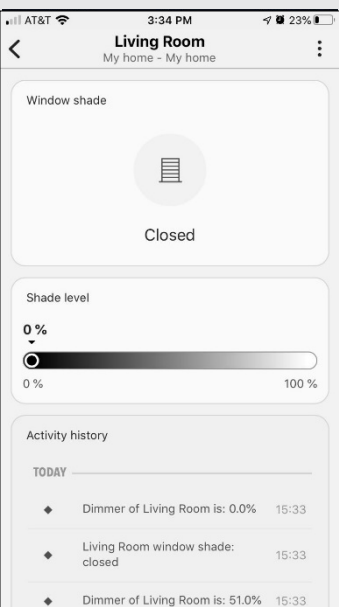

Close the shade by scrolling the (Black) line to the bottom.

STEP 17

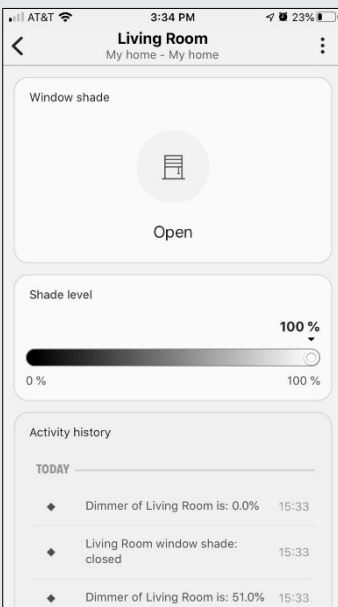

Open the shade, by scrolling the (white) line to the top position.

STEP 14

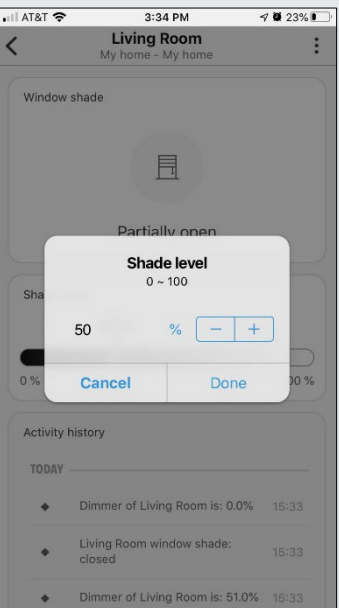

Move the shade to any position desired, by scrolling the line to any position or selecting a specific level.

STEP 15

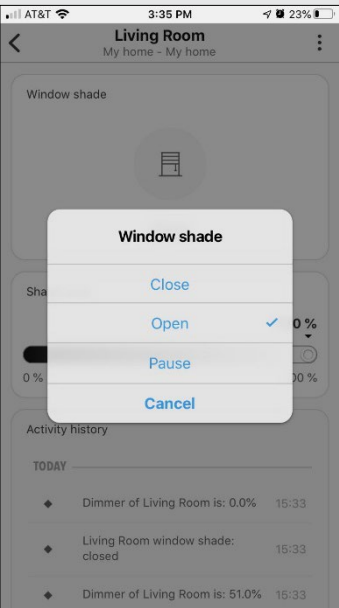

Press and hold the "Shade Icon" and select the Open / Close or Stop your shade.

How to Create a Scene on SmartThings App

Customize your scenes using the SmartThings App and setup the shades to work with many devices in perfect tuned with your lifestyle and routines.

STEP 19

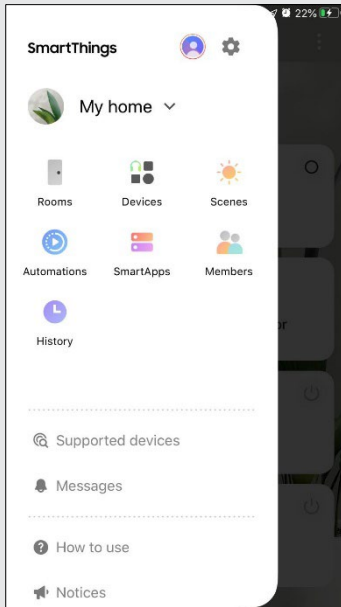

From the home page in the SmartThings App select the “three lines” in the top left corner. After, select “Scenes”

STEP 20

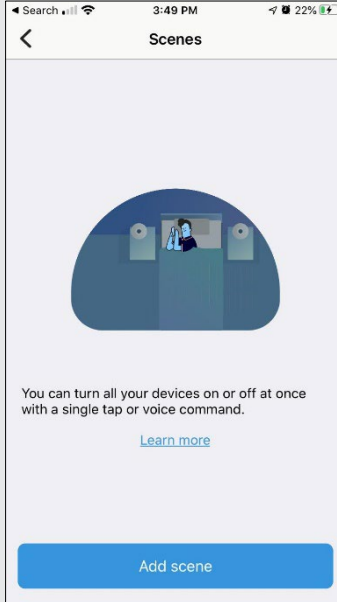

Tap “Add Scene” button to begin programming your desired scene.

STEP 21

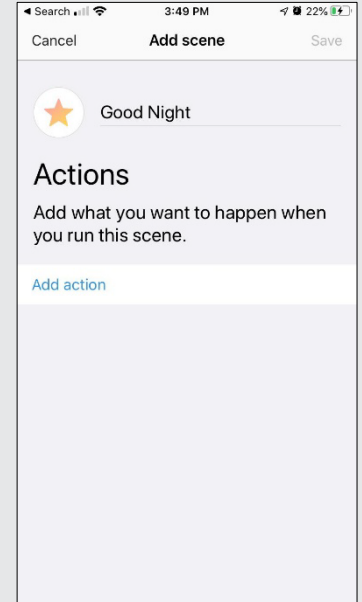

Input your Scene name.
Ex. Good Night
After, select “Add action” to add the devices.

STEP 22

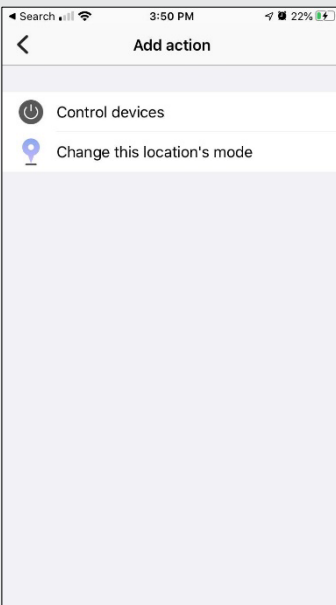

On “Control Devices” option, select the devices to add on your scene.

STEP 23

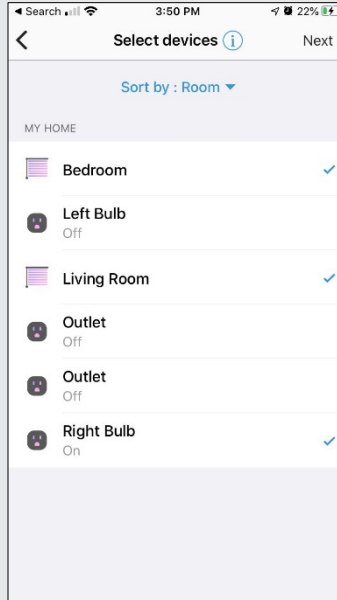

Set the devices that will be added on this scene.

STEP 23

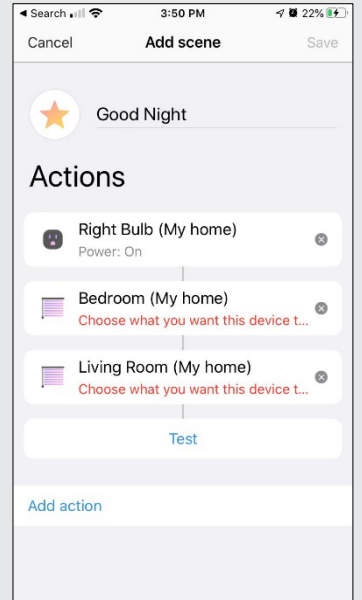

Choose custom heights (by %) or set open/close for selected shades and on/off for lights.

STEP 24

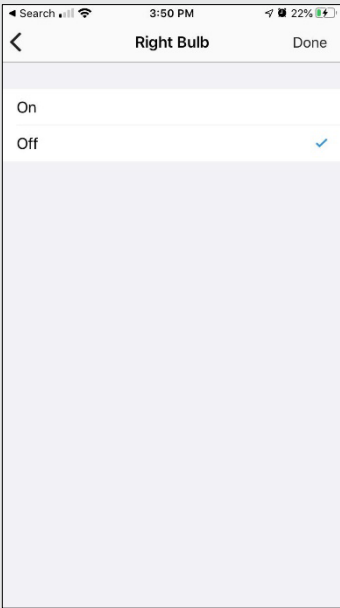

Select On/Off for the light on the selected scene.

STEP 25



Select the "Shade level" for all selected shades .

STEP 26

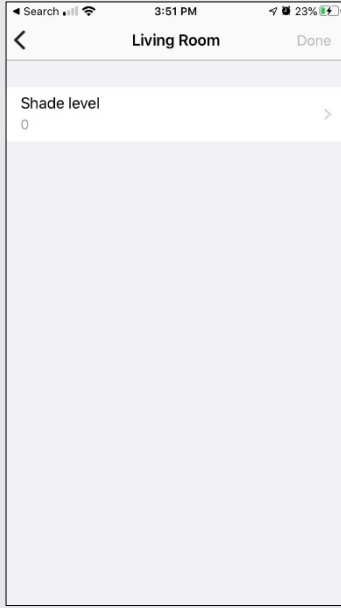

EX: Living Room shade level 0 for close the shade completely.

STEP 27

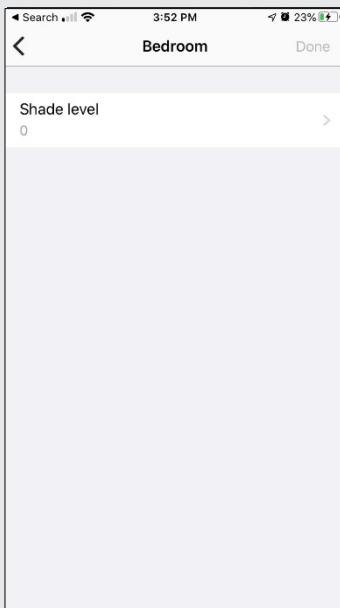

EX: Bedroom shade level 0 for close the shade completely.

STEP 28

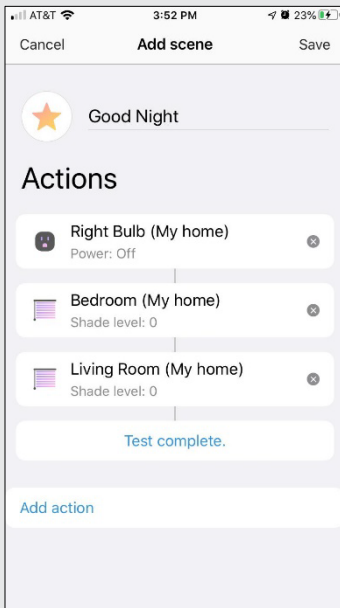

Test the Scene to confirm the set up programmed for each device

STEP 29

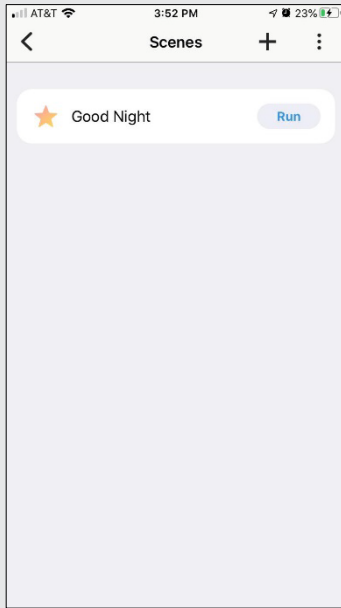

After test, the scene will be available for activated.

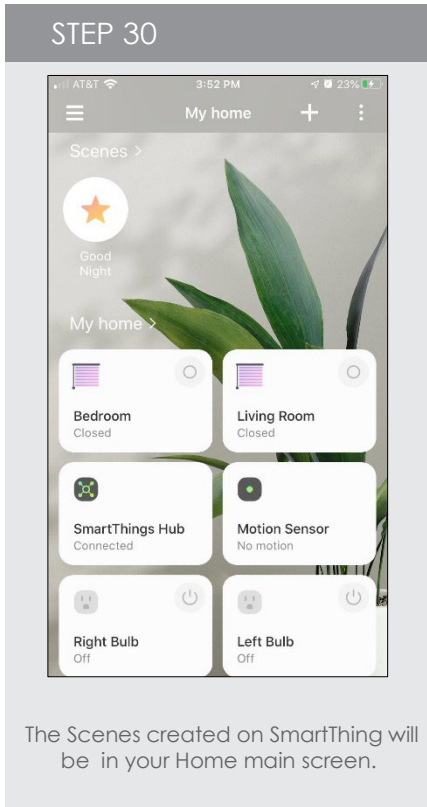

TSS Pro Hub – Smart Things

FREQUENTLY ASKED QUESTIONS

Can I use the SmartThings on my iOS Device?

Yes, if you can download the SmartThings App free from App Store and start your experience controlling the TSS Shades through the App.

How Can I connect my window treatment to SmartThings?

The SmartThings cannot add a window treatment directly. TSS shades and Pro Hub is required to allow the successful association of both platforms.

Can I use the SmartThings Integration without a SmartThings Hub?

Yes, we can link your TSS account to SmartThings App, but if you don't have the SmartThings Hub you won't be able to add and controlling additional devices like Motion Sensors, Lights, Lock doors, etc.

Any Questions,

Please visit www.theshadestore.com

Or

SAMSUNG – SmartThings Support
Phone: + 1-800 726 7864